



📍 Marina Hramina, Murter, Croatia

# Bavaria Cruiser 41 | MH 72 (ID: 2195)

Sailboat Bavaria Cruiser 41 "MH 72" is located in **Marina Hramina, Murter, Croatia**. Built in year **2017**, it provides accommodation for **7 people** in **3 cabins**, with **2 toilets and shower(s)**.

## Specification

| Year of build | Length  | Berths | Cabins     | Engine x 1   | Fuel tank    |
|---------------|---------|--------|------------|--------------|--------------|
| 2017          | 12.35 m | 7      | 3          | 40 hp        | 210 l        |
| Draft         | Beam    | WC     | Water tank | Mainsail     | Headsail     |
| 2.09 m        | 3.95 m  | 2      | 360 l      | furling/roll | furling/roll |

[CLICK HERE FOR MORE INFORMATION](#)

or scan the following QR code >



|                        |  |
|------------------------|--|
| <b>Comfort</b>         | <ul style="list-style-type: none"> <li>✓ Bed linen</li> <li>✓ Blankets</li> <li>✓ Pillows</li> <li>✓ Towels</li> </ul>   |
| <b>Deck</b>            | <ul style="list-style-type: none"> <li>✓ Anchor with chain</li> <li>✓ Bathing platform</li> <li>✓ Bilge pump - Mechanic</li> <li>✓ Bimini top</li> <li>✓ Boat hook</li> <li>✓ Bosun's chair (Safe seat) (boatswain's chair)</li> <li>✓ Cockpit table</li> <li>✓ Cockpit/stern, outside shower</li> <li>✓ Deck brush</li> <li>✓ Dinghy</li> <li>✓ Electric anchor windlass</li> <li>✓ Fenders</li> <li>✓ Fuel funnel</li> <li>✓ Gangway</li> <li>✓ Impeller</li> <li>✓ Jerry cans for diesel</li> <li>✓ Main Deck Compass</li> <li>✓ Mooring ropes</li> <li>✓ Plastic bucket</li> <li>✓ Reserve motor oil</li> <li>✓ Sprayhood</li> <li>✓ Swimming ladder</li> <li>✓ Teak cockpit</li> <li>✓ Water hose</li> <li>✓ Winch handles</li> </ul> |
| <b>Entertainment</b>   | <ul style="list-style-type: none"> <li>✓ DVD player</li> <li>✓ LCD TV</li> <li>✓ Radio CD player</li> </ul>  |
| <b>Galley</b>          | <ul style="list-style-type: none"> <li>✓ Gas bottles</li> <li>✓ Gas cookers</li> <li>✓ Hot water</li> <li>✓ Kitchen utensils (Galley equipment, cutlery)</li> <li>✓ Oven</li> <li>✓ Refrigerator</li> <li>✓ Sink</li> <li>✓ Water pump</li> </ul>  |
| <b>Interior</b>        | <ul style="list-style-type: none"> <li>✓ Barometer</li> <li>✓ Thermometer</li> <li>✓ Toilet paper</li> </ul>   |
| <b>Navigation</b>      | <ul style="list-style-type: none"> <li>✓ Autopilot</li> <li>✓ Binoculars</li> <li>✓ Bow thruster</li> <li>✓ GPS chart plotter</li> <li>✓ Hand bearing compass</li> <li>✓ Log, Speed, Depth- echo sounder</li> <li>✓ Navigation (Nautical) charts and nautical guide</li> <li>✓ Navigation set</li> <li>✓ Pilot book</li> <li>✓ Wind instrument/Anemometer</li> </ul>   |
| <b>Safety</b>          | <ul style="list-style-type: none"> <li>✓ Distress signals</li> <li>✓ Emergency tiller</li> <li>✓ Fire extinguisher</li> <li>✓ First aid kit</li> <li>✓ Fog horn</li> <li>✓ Life belts (Safety harness)</li> <li>✓ Life buoy + Flashing light</li> <li>✓ Life jackets</li> <li>✓ Oars (Paddles)</li> <li>✓ Search light</li> <li>✓ Set of tools</li> <li>✓ Spare parts</li> <li>✓ Torch</li> <li>✓ VHF radio</li> </ul>   |
| <b>Yacht electrics</b> | <ul style="list-style-type: none"> <li>✓ Batteries</li> <li>✓ Battery charger</li> <li>✓ Bilge pump - Electric</li> <li>✓ Heating</li> <li>✓ Plug 220V, 12 V</li> <li>✓ Pump</li> <li>✓ Shore connection 220 V</li> <li>✓ Start battery</li> </ul>   |

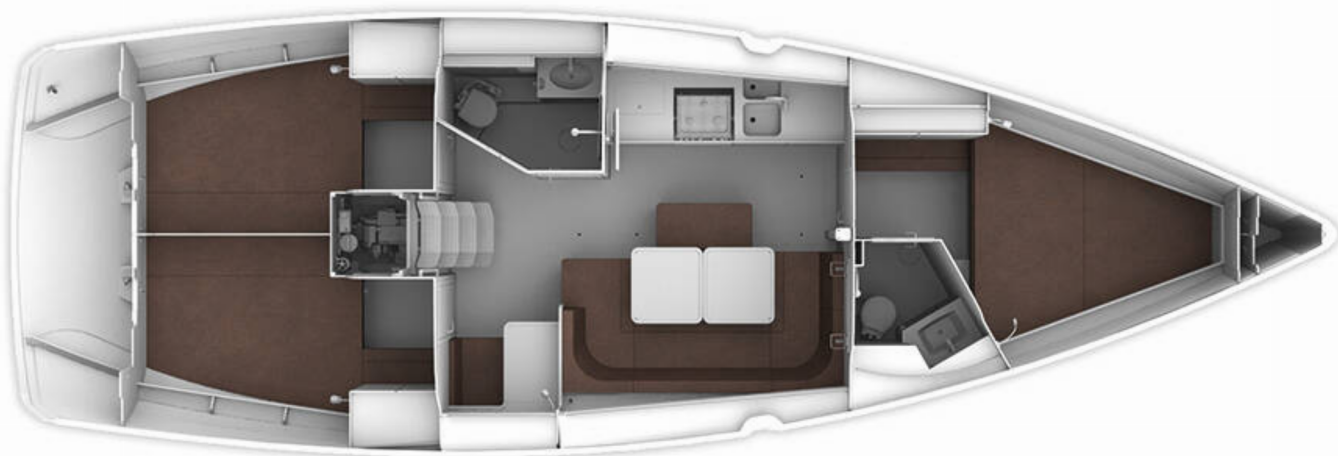







**Check prices and availability**

**CLICK HERE**

# We love having you on board!

**DISCLAIMER** This document is not contractual. All specifications are given in good faith and offered for informational purposes only. Yacht inventory, specifications and charter prices are subject to change without prior notice.